

# Kitchen Measuring Guide

## Diagram 1 - the floor plan

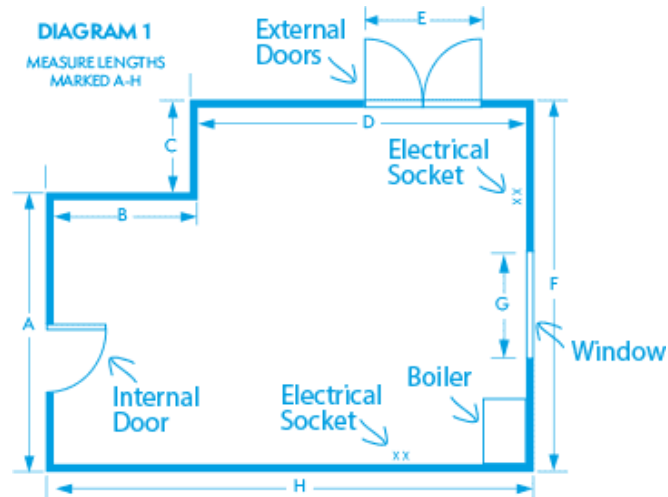

- Measure each individual wall, including door and window openings. Your space could be square, T-shaped or L shaped, as shown.
- Mark where all the windows and doors are as well as which way they open, noting whether they are external or internal doors.
- Add in electrical sockets and any existing plumbing as well as fixed objects such as boilers, radiators, or boxed in pipes.

## Diagram 2 - the wall plan

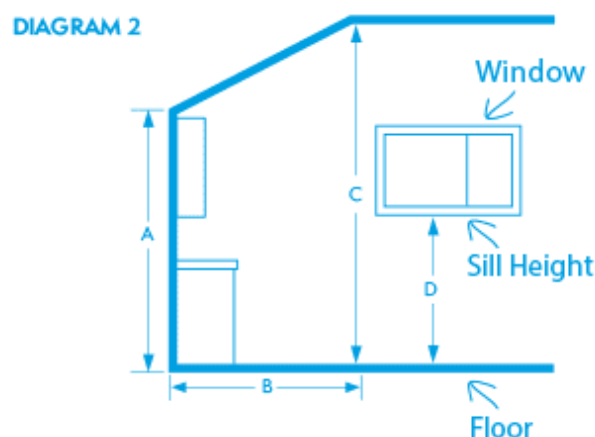

- Your new room may have a sloping ceiling or be a room with eaves. Make sure you measure the tallest (C) and shortest (A) heights as well as how far into your room the eaves extend (B).
- Measure between the floor and the bottom of your windows (D).